

# Big Is Beautiful

Welcome to the largest restaurant floor plates on the Noida Expressway



# How big are your dreams?

No matter the height of your ambition or the speed at which you want to grow. City Center 150 can offer it to you. Located at the heart of Sector 150, it is the regions most premium fine-dining address. Move out of cramped restaurants that Noida is known for and move into a space that is truly deserving of your dreams.



Blackberry

Blackberry

Lenovo

TYO KEDONDA

PRADAA

NIKEE

VERSHACE

VERSHACE

CHANEL

ZARAA

CAMPUS

TAYLER

VERSHACE

VERSHACE

VERSHACE

VERSHACE

VERSHACE

ADDIDAS

ALENN SOLLY

FASHIONN

PRADAA

GUPP

ADDIDAS

NIKEE

CHANEL

ZARAA

CAMPUS



- Al-fresco Style High-street Retail
- Located On A 30 M Wide Road
- Expansive Terraces For Dining With Bio-diversity Park Views
- Overlooking A 40-acre Park
- 500+ Ft. (158 M) Frontage For High Visibility

• Provision For 24x7 Operations\* • Ample Basement Parking Space • Central & Easily Accessible Location



# How far would you like to go?

With City Center 150, you wouldn't have to go very far at all. Located in a premium catchment with the TCS campus and many well-settled residential complexes as its neighbours, giving you a strong catchment with an unbeatable product.

0 mins drive  
to noida's most  
premium sector

15

mins drive  
to film city,  
greater noida\*

30

mins away  
from sector 18,  
noida\*

30

mins drive  
to jewar  
international  
airport\*

# Location

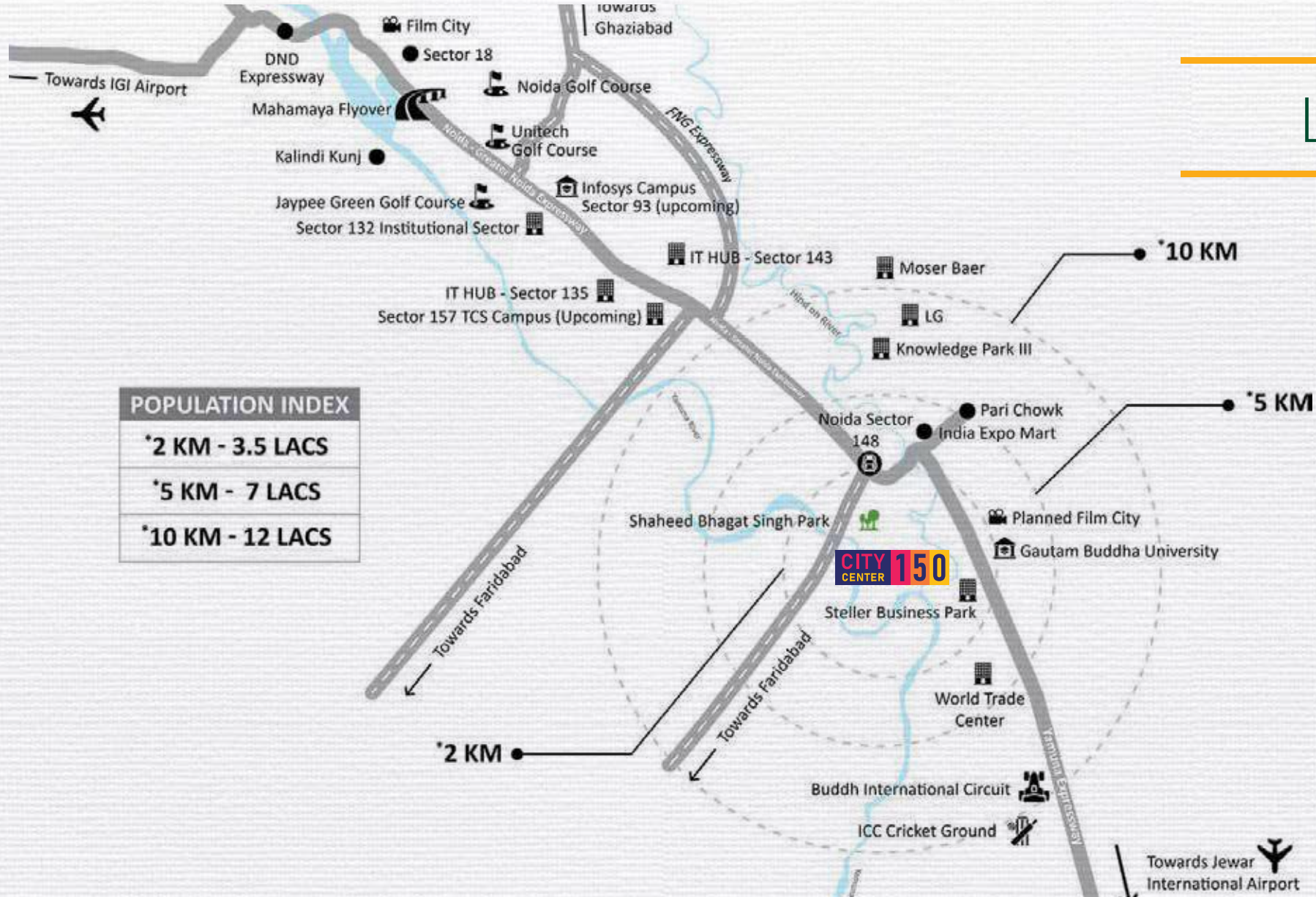



Big leaps have a new address

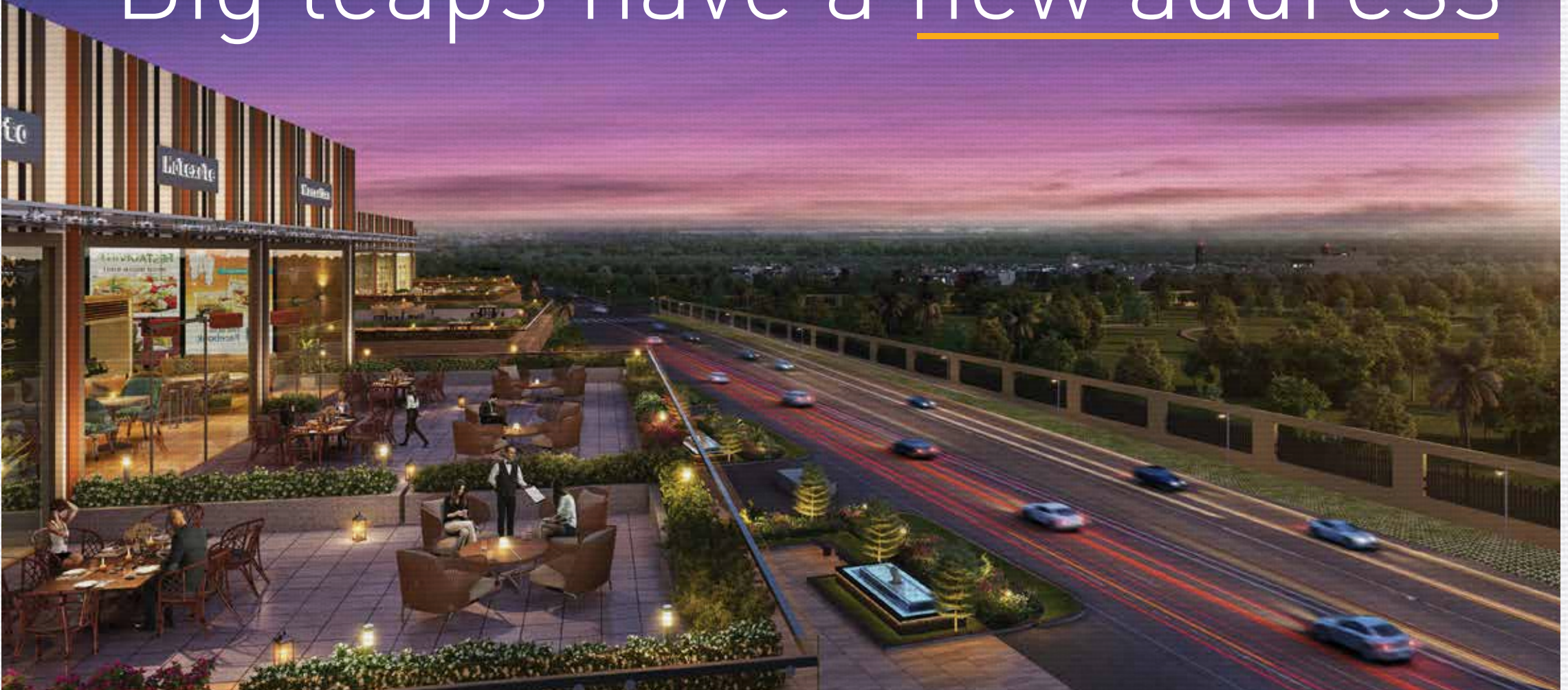

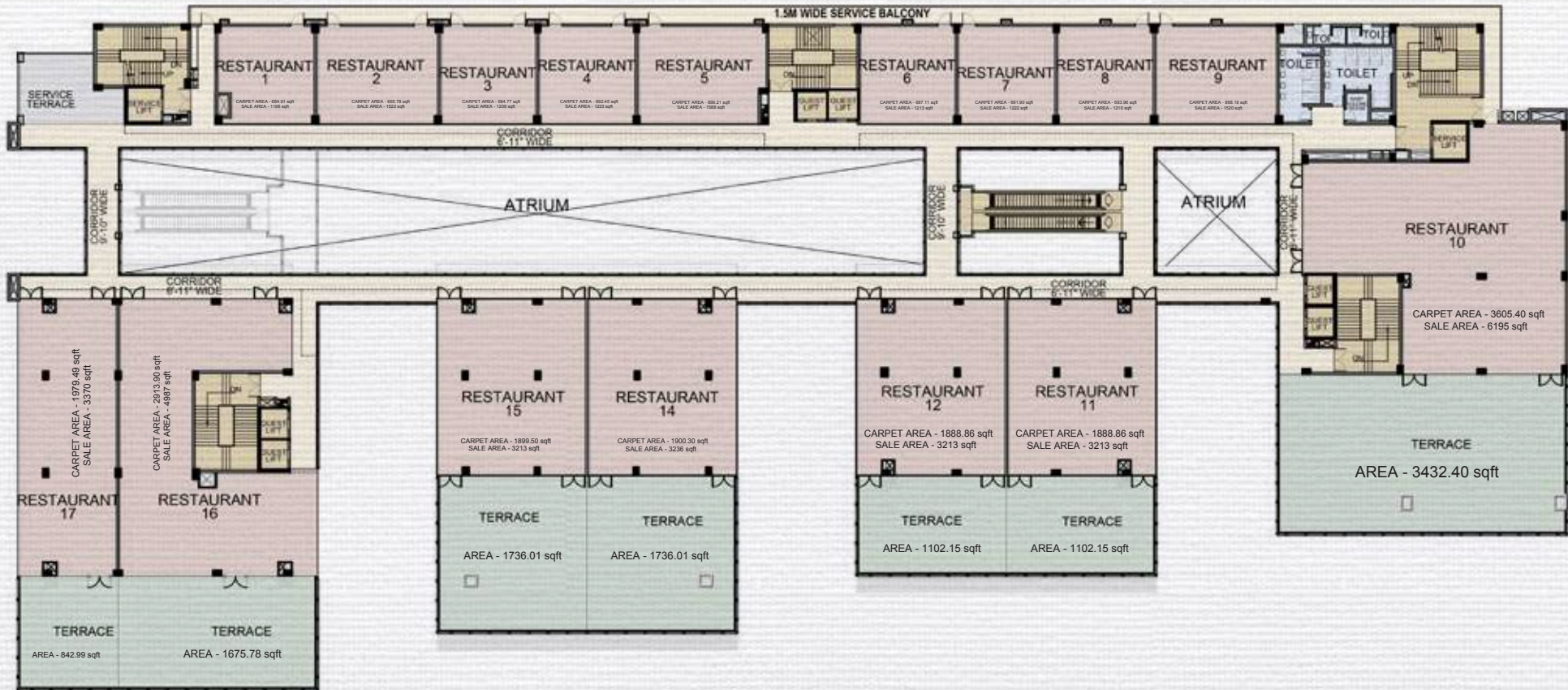

# Third Floor

## Payment Plan

₹ 29.90 LAKH  
(ALL INCLUSIVE)

### PAYMENT PLAN

Stage	Payable
At the time of Booking	Rs. 2,00,000/-
Within 30 days of Booking	30% of BSP(Less Booking Amount)
On Completion of top Floor slab	30% of BSP
On Offer of Possession	40% of BSP

\* Government taxes, GST extra as applicable

# Ready to make it BIG?

Contact Us at: 0120 4909090

